

## Office Bearers 2004/2005

---

President: Geoff Allen 9568 4380 Vice President: Gavin Betts 9807 4661 Secretary: Tony McLachlan 9840 7716  
Treasurer: Phillip Dunstan 9808 7510 Auditor: Ian Trivett 9802 5110 Public Officer: Laurie Stuart 9807 9793

### Committee Members:

Wolfgang Becker 9560 9278 Bruce Hartland 9560 5708 Cameron McKerral 9885 5525 Laurie Stuart 9807 9793

---

## PRESIDENT'S REPORT

Although we have had our Annual General Meeting and some Office Bearer positions have changed, we will have to wait until a later date, for a report of the evening's events and the changes to the Committee. Peter Stacey.

---

**Final reminder that Club fees were due on 1<sup>st</sup> of July** for the 2005 – 2006 club year. If you have not paid yet, then you are overdue. Just think what would you do if you couldn't come into the clubrooms to work or play? What would you read if you didn't get the newsletter? Also, the sooner you pay the sooner the next committee knows how much money they have to spend on your pleasure. **If you haven't paid yet, please pay your subscription.**

Geoff Allen.

### Editorial

As an 'ordinary' - non-involved – member, I found it easy to forget, or not consider too deeply, the work that others were doing, to make it possible to enjoy all the benefits, which membership of the Waverley Woodworkers club provided me.

However, standing in for our Editor Peter Hughes, has brought the work and involvement of other members very much to my attention. It clearly shows that for any organisation to function effectively, it is necessary for more than a committed few, to participate and assist in the various jobs that make a club such as this successful.

Assisting or being involved can take many forms. While it is important to ensure we have a strong, active and capable committee. It can also be by members participating in Club activities. Ensuring that we turn up on time, or help set up for the event. Not being the first to leave, but help tidy up after a meeting or group activity. Cleaning up after using the club facilities or equipment. Being dependable when others are relying on our input, whether this means staffing the workshop, supplying reports on time, or any other job we have accepted or volunteered to do.

Our newsletter could be far more informative and interesting, with greater general involvement by you the members. This could take the form of writing an article, taking or supplying pictures. Also references to information in books, the internet or even articles of general interest. You might be surprised at how many other members also find that item interesting.

E-mail addresses for Newsletter distribution, are very slow in arriving. To date, I have only 13 from the whole club. Distributing the newsletter electronically via the Internet, not only saves the club money, it gives us much more flexibility in format and content. We can vary the size of the newsletter without affecting the cost of the production. Unlike the printed format, which automatically adds the cost of an additional sheet of paper and the cost of copying an additional side or two, even if the whole page/ side is not fully utilised. This adds pressure on the editor ☹ to either trim the content, to avoid the extra page, or to find additional articles and fill the extra space to justify the additional cost.

Whilst I have been asking for your E-mail addresses, it is NOT necessary for you to have the internet, or even have a PC at home, to enjoy the benefits of obtaining the newsletter electronically. Have your family, friends or neighbours got the internet? It is available from public places such as Libraries, internet cafes and clubs, U3A etc. Just think, here is an opportunity to learn another new skill. ☺

Peter Stacey

## JUST TURNING

**27<sup>th</sup> June** Ten members present.

*Ron Jones* brought along a sycamore utensil holder with four coats of Danish Oil and a wax finish. Ron also showed another of his multi timber pens which included Padouk, cypress pine, maple, silky oak, as well as pine and walnut veneers.

*Peter Stacey* brought along pieces of freshly cut wattle with a piece for each member to hopefully turn an item by the end of the year. Peter also showed a small vase turned from the wattle to show the grain and colour. Max Bray brought along timber for identification from members.

*Phil Dunstan* brought along a small bowl made from fruitwood supplied by Ron. Phil is trying the freezer method for drying timber. (Three weeks in and two weeks out?). Then finish turning. It has moved so Phil may do some more work on it. Phil also brought a table lamp made from mulga, finished with EEE and Shellawax.

*Bob Lorensene's* contribution was several pieces of myrtle for members to share.

Helene's 'show', was several turned rosewood drawer knobs, for a jewellery box she is making.

Helene Longton.

**4<sup>th</sup> July** 11 members present.

*Geoff Allen* brought along his 'green' turned black wattle, from the previous week. This was turned thin into a 'boater' hat style shape. Unfortunately the base has cracked and the timber has started to warp. Geoff also showed a vase he turned from red gum, and in order to give it an antique look he rough sanded it and burnt the lower part with a butane torch.

*Garry Flanigan* showed a large partly turned piece of Blackwood which had small cracks which he was concerned about. Advice was given to fill the faults before further turning.

*Peter Stacey* brought along empty detergent bottles which could be rinsed and used for glue, as well as some lemons for members. Peter also showed a picture (off the web) of a very ornate laminated bowl. Peter also returned a blade from the large bandsaw, which he sharpened. Thanks Peter. (Here's hoping that it cuts better. P.S. ☺)

*Bob Morrison* showed a lidded container made of cypress pine. Bob also brought along some blocks of red gum, cypress pine, and Chinese elm for members to use.

*Ron Jones's* items were two lidded containers, one of Cootamundra wattle and the other had a rosewood base, Huon pine lid and red gum knob.

*Bob Lorensene* brought his black wattle piece turned into a bowl, which he will now leave to dry further before finishing. Bob also turned a shape for a bottle opener, and an unnamed timber into a stylised Madonna.

*Ray Austin* commented on the layout and photos in the June newsletter. Well done Peter.

*Helene Longton's* contribution was a large red gum lidded container with the knob completed. Helene also showed a small rosewood bowl.

The evening ended with Bob Morrison giving a demonstration of his new off centre turning a goblet.

Helene Longton.

---

## Linseed Oil as a Timber Preservative.

If you also have an interest in using Linseed Oil as a timber treatment, here is some information that I obtained on the internet from the [E.E. Zimmerman Company/Elroy Turpentine Company Pittsburgh USA](#). Further information is available on the Web and members wishing to use this or similar products, should make their own enquiries to ensure safe and appropriate use. Peter Stacey.

### **Boiled Linseed Oil**

100% pure. Scientifically treated to shorten drying time. Used to refinish antiques, preserve exterior wood and concrete, inhibit rust, and as an additive for oil based finishes.

### ***Specs:***

E-Z Boiled Linseed Oil, when used to produce a hand rubbed wood finish, first remove the old finish with E-Z Paint & Varnish Remover. Sandpaper as needed and clean surface with E-Z Mineral Spirits. Saturate a clean cloth with product and rub in thoroughly. Allow the oil to soak in for 30 minutes before removing excess with a clean dry cloth. Allow oil to dry, at least 24 hours, before applying additional coats. When used as a finish to provide exterior wood protection, apply a mixture of 2 parts linseed oil and one part E-Z Gum Spirits of Turpentine or E-Z Mineral Spirits with a brush. Wipe off excess oil. For more than one coat, wait at least one week to allow effective penetration and complete drying. **DO NOT USE ON REDWOOD!** When used as a rust inhibitor for tools or other metallic items, apply a thin coat, using a brush or rag, to the bare metal surface. When used as a paint additive in oil based paints, varnished and enamels, consult finish product manufacturer's recommendations. Linseed oil will improve leveling, provide smoother brushing and increase gloss. Never heat linseed oil, use only at normal room temperature. For applications requiring slower drying, choose E-Z Raw Linseed Oil.

## Raw Linseed Oil

100% pure natural flaxseed oil with no driers or chemical additives. Use to refinish antiques, preserve exterior woods and concrete, inhibit rust, and as an additive for oil base finishes.

### **Specs:**

E-Z Raw Linseed Oil, when used to produce a hand rubbed wood finish, first remove the old finish with E-Z Paint & Varnish Remover. Sandpaper as needed and clean surface with E-Z Mineral Spirits. Saturate a clean cloth with product and rub in thoroughly. Allow the oil to soak in for 30 minutes before removing excess with a clean dry cloth. Allow oil to dry, at least 24 hours, before applying additional coats. When used as a finish to provide exterior wood protection, apply a mixture of 2 parts linseed oil and one part E-Z Gum Spirits of Turpentine or E-Z Mineral Spirits with a brush. Wipe off excess oil. For more than one coat, wait at least one week to allow effective penetration and complete drying. **DO NOT USE ON REDWOOD!** When used as a rust inhibitor for tools or other metallic items, apply a thin coat, using a brush or rag, to the bare metal surface. When used as a paint additive in oil based paints, varnishes and enamels, consult finish product manufacturer's recommendations. Linseed oil will improve leveling, provide smoother brushing and increase gloss. Never heat linseed oil, use only at normal room temperature. For applications requiring faster drying, choose E-Z Boiled Linseed Oil.

### **UNUSUAL FIRE & EXPLOSION HAZARDS:**

**Linseed oil will oxidize and can cause spontaneous heating. Avoid spontaneous combustion of contaminated rags or other ignitable absorbent material by immersing in water immediately.**

---

### Notices and Reminders

**Turning lessons.** Four members started lessons with Bob Morrison on 12th July, at 6:30 to 9:30 pm. for six weeks.

**Sunday 14<sup>th</sup> August.** The Casterton Community Art and Craft Association is holding their 15<sup>th</sup> Annual Woodcraft Show. Venue: Casterton Town Hall 10am. To 3:30pm. Contact: Ph. 03 5581 2070.

**The Woodturning SIG.** (Special Interest Group).

**During July and August, meet only on the 1<sup>st</sup> and the 3<sup>rd</sup> Mondays of the month, at 7:30 pm.**

**Monday 19<sup>th</sup> September.** Ken Cort will be demonstrating tool sharpening and long hole boring at Knox and District Woodworkers from 9am.- 3pm. Depending on numbers attending, a small charge will be made for lunch and morning tea. Ken will also be demonstrating at the "Working with Wood Show".

**24<sup>th</sup> – 25<sup>th</sup> September.** The Mildura Wood Show is held by the Mildura Woodturners and Woodworkers Inc. Venue: Mildura Woolshed Complex, Cureton Ave. Mildura. Contact: 03 5023 1172 or 03 5022 1265.

**7<sup>th</sup> – 9<sup>th</sup> October.** Melbourne Timber & Working with Wood Show. Venue: Melbourne Exhibition Centre, Southbank. (Jeff's Shed)

**Barwon Valley Woodwrights (Geelong) 15th Annual Woodcraft Exhibition.** Saturday 29th - Sunday 30th Oct. 2005 10 AM – 4 PM Daily. Admission \$3.00. Demonstrations and sales of Woodturning and Wood Carving. Includes Secondary Schools competition. Location: State Government Offices building Cnr. Little Malop St & Fenwick Geelong. **Melways Ref. 401 F4) 2002 edition. (Melways Ref. 452 A3) 2004 edition.**

**Pen kits** are available at the club for \$2.50 each or \$12.50 for five kits.

---

### *Time for a smile.*

**Real Meanings.** *The Washington Post published a contest for readers in which they were asked to supply alternative meanings for various words. The following were some of the winning entries:*

Abdicate (v.), to give up all hope of ever having a flat stomach.

Esplanade (v.), to attempt an explanation while drunk.

Flabbergasted (adj.), appalled over how much weight you have gained.

Negligent (adj.), describes a condition in which you absentmindedly answer the door in your nightie.

<p><b>Please note: The closing date for input to the August Newsletter is 26th August 2005</b></p>
--

---

## WODWORKING TIPS FROM “WOODSMITH”

Copyright of August Home Publishing Co. Publishers of the “Woodsmith”, “Shopnotes” and “Workbench” magazines, all worth a read. Used by Waverley

### Mortising on a Router Table

You can make mortises with a fixed-base router mounted in a router table. To make a mortise this way, you have to lower a work piece onto a spinning bit. It takes a little bit of setup to do this safely and correctly.

You'll need three things for the technique: two stop blocks clamped to the router table fence, and a guide rail to keep the work piece from kicking out from the fence.

**Stop Blocks** — The location of the stop blocks is important, so take some time to position them correctly. The idea is to clamp them in place so that when the work piece is butted against them, the bit is aligned with one end of the mortise or the other (see Illustration).

**Guide Rail** — As for the guide rail, it's just a scrap 2×4 glued or screwed to a plywood clamp pad (Main Photo). Position the clamp pad so that the work piece can slide smoothly between the rail and router table fence, and clamp it firmly in place.

**Rout Mortise** — Before routing, drill a starter hole at the front of the mortise (Inset Photo). This creates a pocket that fits down over the router bit. Then, cutting the mortise is as simple as butting the work piece against the back stop block, lowering it onto the spinning bit, and pushing it forward until it hits the front stop block. Rout the mortise in a series of progressively deeper passes until reaching the desired depth.

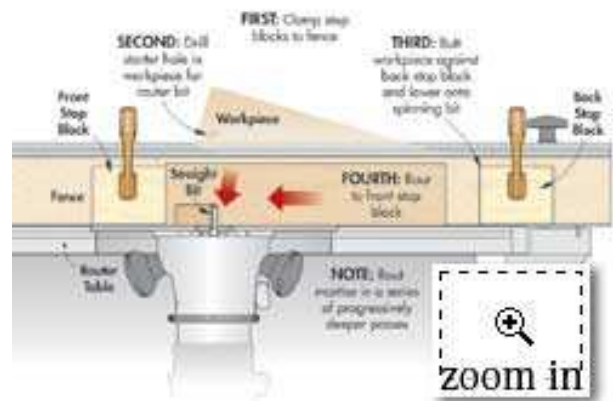

Wyatt Myers  
Online Editor, *Workbench*

### Install Screws in Close Quarters

Recently, when attaching a solid-wood top to a project, I had to reach in through a tight space to tighten screws. There wasn't enough clearance to use a cordless drill or a screwdriver, but I remembered that screwdriver bits from my drill fit exactly into a 1/4" socket. I mounted the bit on the socket wrench and easily tightened the screws.

Wyatt Myers  
Online Editor, *Workbench*

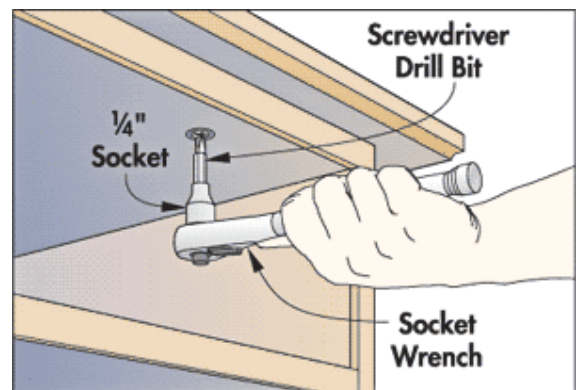

Woodworkers Inc. by permission)

---

## Members showcase



### Photo information:

For this month's quiz, see if you can connect the pictures with the makers as listed in the July 4<sup>th</sup> Woodturning report.

**Discounts Available from the following:** The following companies offer discounts to members of the Waverley Woodworkers. **Note:** Discounts are only available on presentation of your current membership card.

<b>Australian Wood Panels</b> , 40-42 Winton Rd., Clayton	9543 5033
<b>Baileys Toolbank</b> , Unit 4 Rowen Crt. Box Hill	9897 1911
<b>Blackwoods</b> , 31 Fowler Rd., Dandenong (ask for Cyril)	9518 2222
<b>Gus-Tec</b> , 521 Mountain Highway, Bayswater ( <b>Note name change</b> )	9427 8444
<b>Note: New address:</b> Opposite the end of Mountain Highway	
<b>Dixon's Hardware</b> , 304 Stephenson's Rd., Mount Waverley	9888 1813
<b>Flatman's Timber &amp; Hardware</b> , High Street Road, Syndal	9802 9211
<b>A. Lewis &amp; Co</b> , 302 Jasper Rd., Ormond	9578 6218
<b>Malvern Paint &amp; Timber Finishes</b> , 1933 Malvern Rd., Malvern East	9885 2883
<b>Magnetic Abrasives</b> , 286 Neerim Rd., Carnegie	9571 6811
<b>Mathews Timbers</b> , 125 Rooks Rd., Vermont	9874 1666
<b>Moorabbin Timber</b> , 230 Wickham Rd., Moorabbin	9553 0155
<b>Sachy's Industries</b> , 43 Browning Drive, Glen Waverley	9803 2370
<b>Shiver me Timbers</b> , 217 Kororoit Creek Rd. Williamstown	9397 5993
<b>Woodworking Warehouse</b> , 11 Citrus St. Braeside	9587 3999

If you know of any other source of discounts for members, or if you have difficulty obtaining a discount from any of the above, during Peter Hughes absence, please contact Peter Stacey, on ph **9572 3090**, or by e-mail [petersta@melbpc.org.au](mailto:petersta@melbpc.org.au)

**COPYRIGHT:** Except where otherwise stated, other woodworking clubs may use items from our Newsletter. We do ask that such be without alterations, and that the source be acknowledged.

# Waverley Woodworkers Inc.

Clubrooms: 2 Windsor Ave., Mount Waverley, Vic. 3149 Telephone: 9807 9648

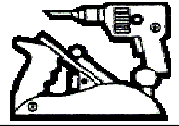

## Workshop Opening Times

<b>Day</b>	<b>Times</b>	<b>Sunday</b>	<b>Closed</b>
Monday	<u>Only Public Holidays</u> for general woodwork.	<u>Special Interest Group Meeting Times</u>	
		<b>Day</b>	<b>Times</b>
Tuesday	9 am – 4 pm.	Monday	9 am – 12 noon - Assisted Woodwork Allocated Basis ( <b>Except on Public Holidays</b> ).
Wednesday	9 am – 12 noon.		
Thursday	<b>Closed</b>	Monday	1:30 pm - 4:30 pm – <b>Carving</b> .
Friday	9 am – 12 noon.	Monday	7:30 pm – 9 pm – <b>Wood Turning</b> . (Only 1st & 3rd Mondays in July & August).
Saturday	9 am – 12 noon December- February. 9 am – 4 pm (March - November).	<b>Club Night</b>	2nd Wednesday of the month 7:30 pm – 9 pm.

---